

Cable Ties



Panduit® offers the most complete selection of cable tie styles, sizes, materials and colors to meet our customers' needs. Panduit cable ties bundle, mount, and identify in countless indoor, outdoor, and harsh environment applications. Panduit cable ties, wiring accessories, and installation tools allow our customers to achieve the lowest total installed cost of managing wire and cable.



- Panduit continues to provide innovative new cable tie designs to meet our customers' application challenges
- Panduit cable ties and wiring accessories can be used in a variety of applications and environments, providing the optimal wire management solution
- Panduit offers a large selection of ergonomic cable tie installation tools – all with consistent, and reliable performance

Panduit leads the industry in the breadth and depth of available cable tie designs created from customer feedback on their application requirements. As with all Panduit products, quality in design and production along with customer service excellence are assured.

Epoxy Applied Swivel Mount

- Swivels 360° to assure proper orientation with harness
- Four inspection holes to check adhesive coverage
- For indoor use only

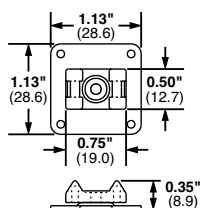

| Part Number | Used with Cable Ties‡ | Mounting Method | Std. Pkg. Qty. | Std. Ctn. Qty. |
|-------------|-----------------------|-----------------|----------------|----------------|
| ASMS-A-X | M, I, S, SGM, SGI | EMA epoxy | 10 | 100 |

‡Cable tie cross section sizes: M = Miniature, I = Intermediate, S = Standard, SGM = Super-Grip® Miniature, and SGI = Super-Grip® Intermediate.

Epoxy Applied Cable Tie Mount Kits

- EMA Epoxy supplied in convenient two-compartment mixer cup with a mixer stick for each cup
- Each cup contains adhesive for three EMS or ASMS mounts
- Epoxy hardens in approximately five minutes
- After full 24 hour cure time, bonding strength will exceed 50 lbs. on a clean, grease-free surface
- Not recommended for use on polyethylene and polypropylene surfaces



| Part Number | Used with Cable Ties‡ | Environment | Epoxy Cups | Mixer Sticks | EMS Mounts | Cable Ties | Std. Pkg. Qty. | Std. Ctn. Qty. |
|-------------|-----------------------|-------------|------------|--------------|------------|------------|----------------|----------------|
|-------------|-----------------------|-------------|------------|--------------|------------|------------|----------------|----------------|

Epoxy Adhesive Only

| | | | | | | | | |
|-------|---|------------------|----|----|---|---|----|---|
| EMA-X | — | Indoors/Outdoors | 10 | 10 | — | — | 10 | — |
|-------|---|------------------|----|----|---|---|----|---|

Epoxy Mounting Kit with EMS Mounts

| | | | | | | | | |
|------------|---------|------------------|---|---|---|---|---|----|
| EMSK3-1-X0 | M, I, S | Indoors/Outdoors | 1 | 1 | 3 | 3 | 1 | 10 |
|------------|---------|------------------|---|---|---|---|---|----|

Epoxy Mounting Kit with EMS Mounts and Cable Ties

| | | | | | | | | |
|----------------|---------|------------------|---|---|----|----|----|----|
| EMSK3-1-3-0 | M, I, S | Indoors/Outdoors | 1 | 1 | 3 | 3 | 1 | 10 |
| EMSK12-4-12-X0 | | Indoors/Outdoors | 4 | 4 | 12 | 12 | 10 | 10 |

‡Cable tie cross section sizes: M = Miniature, I = Intermediate, and S = Standard.

cALUS Tie Mounts – Applied with User Supplied Adhesives

- Solid flat bottom surface provides maximum holding area
- Material: Nylon 6.6
- For indoor use only



| Part Number | Used with Cable Ties‡ | Color | Mounting Method | Std. Pkg. Qty. | Std. Ctn. Qty. |
|-------------|-----------------------|---------|------------------------|----------------|----------------|
| TM1A-C | M | Natural | User Supplied Adhesive | 100 | 1000 |
| TM2A-C | M, I, S | | | 100 | 500 |
| TM3A-C | M, I, S, HS, LH | | | 100 | 500 |

‡Cable tie cross section sizes: M = Miniature, I = Intermediate, S = Standard, HS = Heavy Standard and LH = Light-Heavy.

cALUS Low Profile Tie Mounts – User Supplied Adhesive Mounts

- Low profile design keeps bundle close to mounting surface
- For indoor use only
- Material: Nylon 6.6

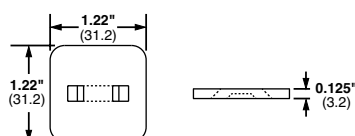

| Part Number | Used with Cable Ties‡ | Color | Mounting Method | Std. Pkg. Qty. | Std. Ctn. Qty. |
|-------------|-----------------------|---------|------------------------|----------------|----------------|
| AM2-C | M, I, S | Natural | User Supplied Adhesive | 100 | 500 |

‡Cable tie cross section sizes: M = Miniature, I = Intermediate, and S = Standard.